



YML01CR-AK1065F LENS



PRODUCT DESCRIPTION

Features:

- High efficiency >90%
- Available in 1 beam pattern
- Optimized for uniform effects
- Lens material Optical grade PMMA
- Lens with holder

Typical applications:

- Stage Lighting
- Street Lights
- Decorative Light
- Down Light

TABLE OF CONTENTS

General Information	2
Usage and Maintenance	2
2D Drawings	3
Optical Characteristics (for 3535 led)	3
Package Information	4
Product Nomenclature	5



General Information (TJ = 25°C)

- Compatible Led Type:

The YML01CR-AK1065F- single lens is optimized for 3535 led

- Beam Angle Type:

An optimized profile in tegrate different front shape erabel the general of one lens model:oval beam (10*65deg)⁽¹⁾

- The Way to Assembly:

The lens should be assembled to the PCB board or MCPCB upon LEDs which provides the most appropriate related position,so as to achieve the best uniform results.

*** Manually installation or if necessary thermal glue are recommended.**

- Fuction:

YML01CR-AK1065F provides excep tional color mixing result with the highest efficiency through careful enginnering and precision manufacturing process.

Usage and Maintenance

- 1.Clean lenses with mild soap and water and a soft cloth.
- 2.Don't use any commercial cleaning solvents on lenses,like alcohol.
- 3.Operating temperature -40℃~+80℃(upper limit +90℃)
- 4.please handle or install lenses with wearing gloves,skin oils may damage lens or optical characteristic.

Notes:

(1) Typical beam divergence will be affected by different LED manufacturers.



2D Drawings (unit:mm)

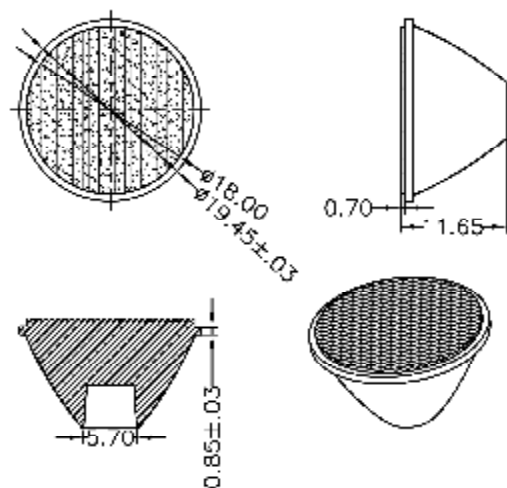

LENS

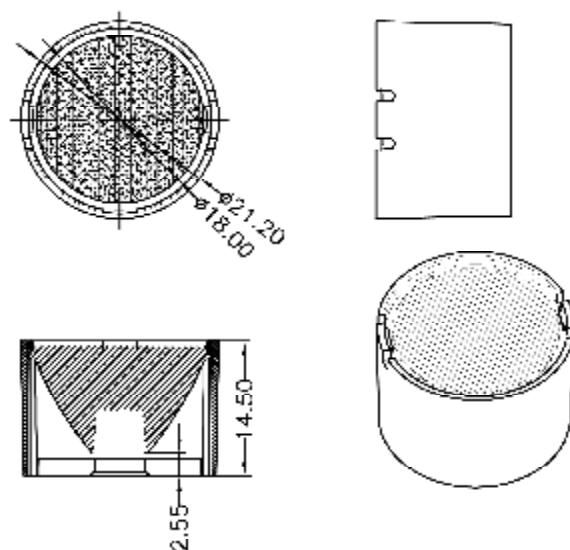

LENS WITH HOLDER

Optical Characteristics (for 3535 LED)

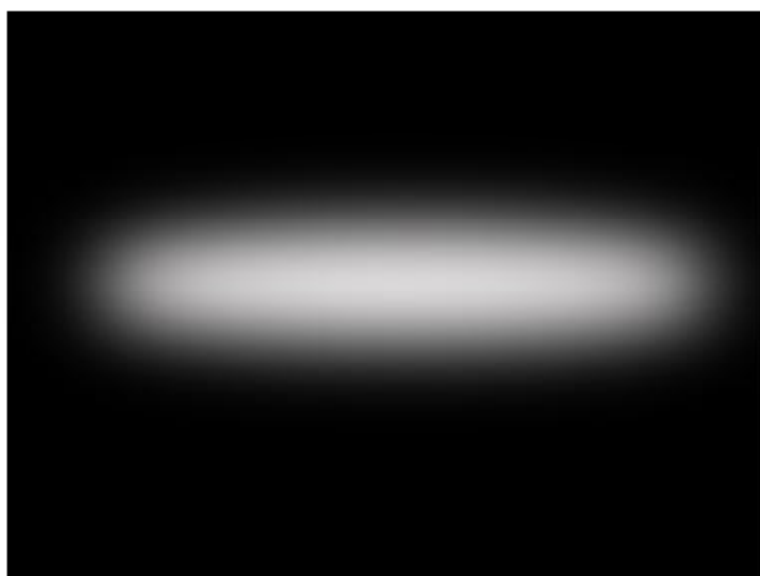
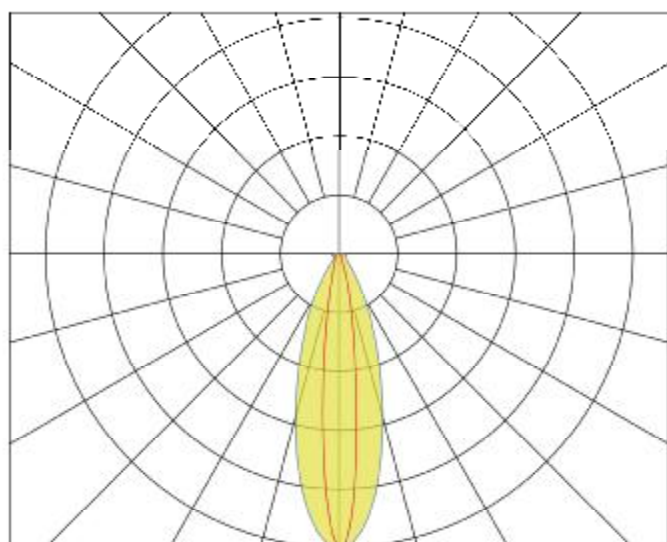



Package Information

Item	Quantity	Total	Size (long*width* high)
Tray	36pcs/tray	36pcs	—
Inner box	10tray/inner box	360pcs	12.5*12.5*12.5 cm
Outer box	18 inner box/outer box	6480pcs	42.0*39.0*39.0 cm

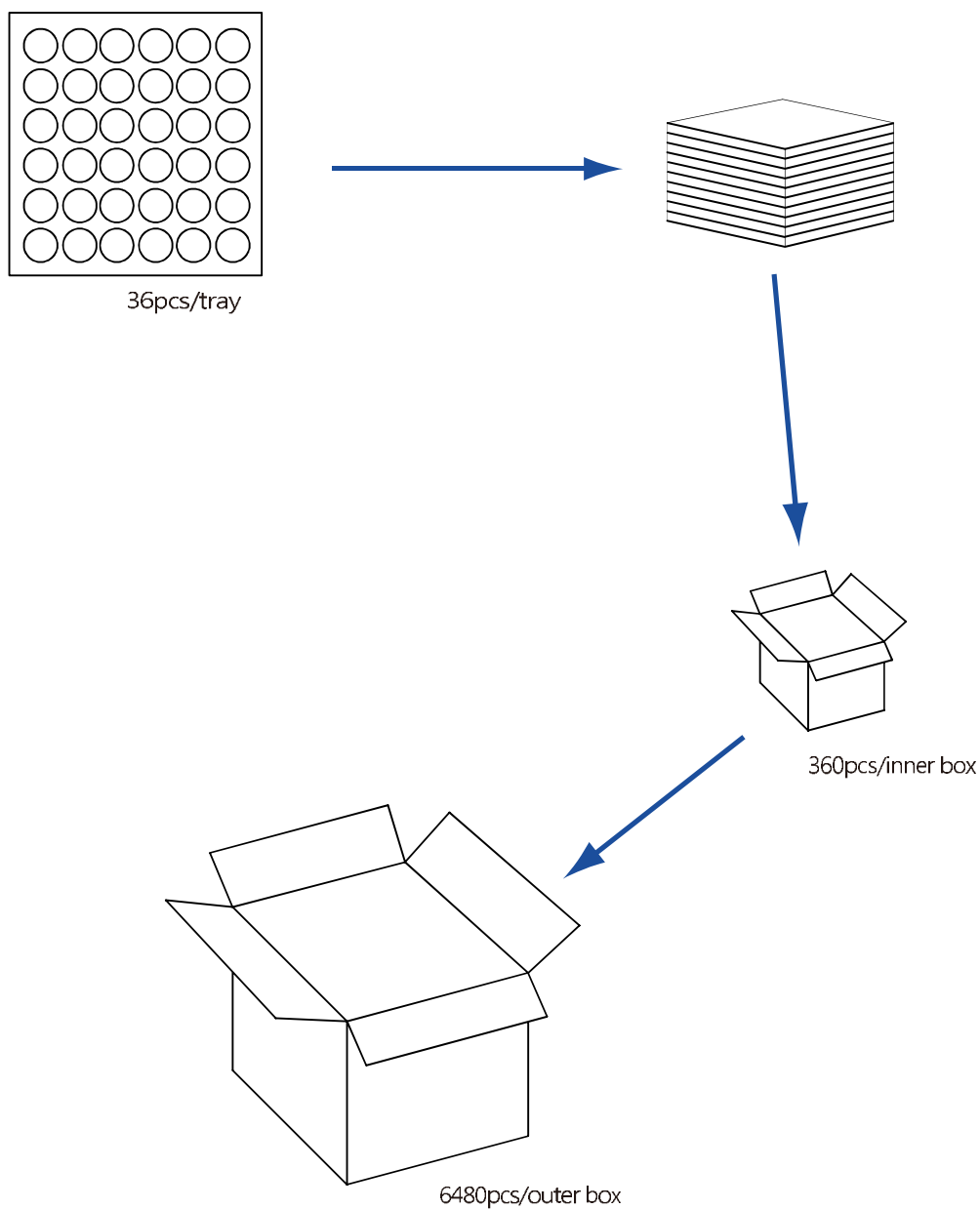



Product Nomenclature

